

[illegible]

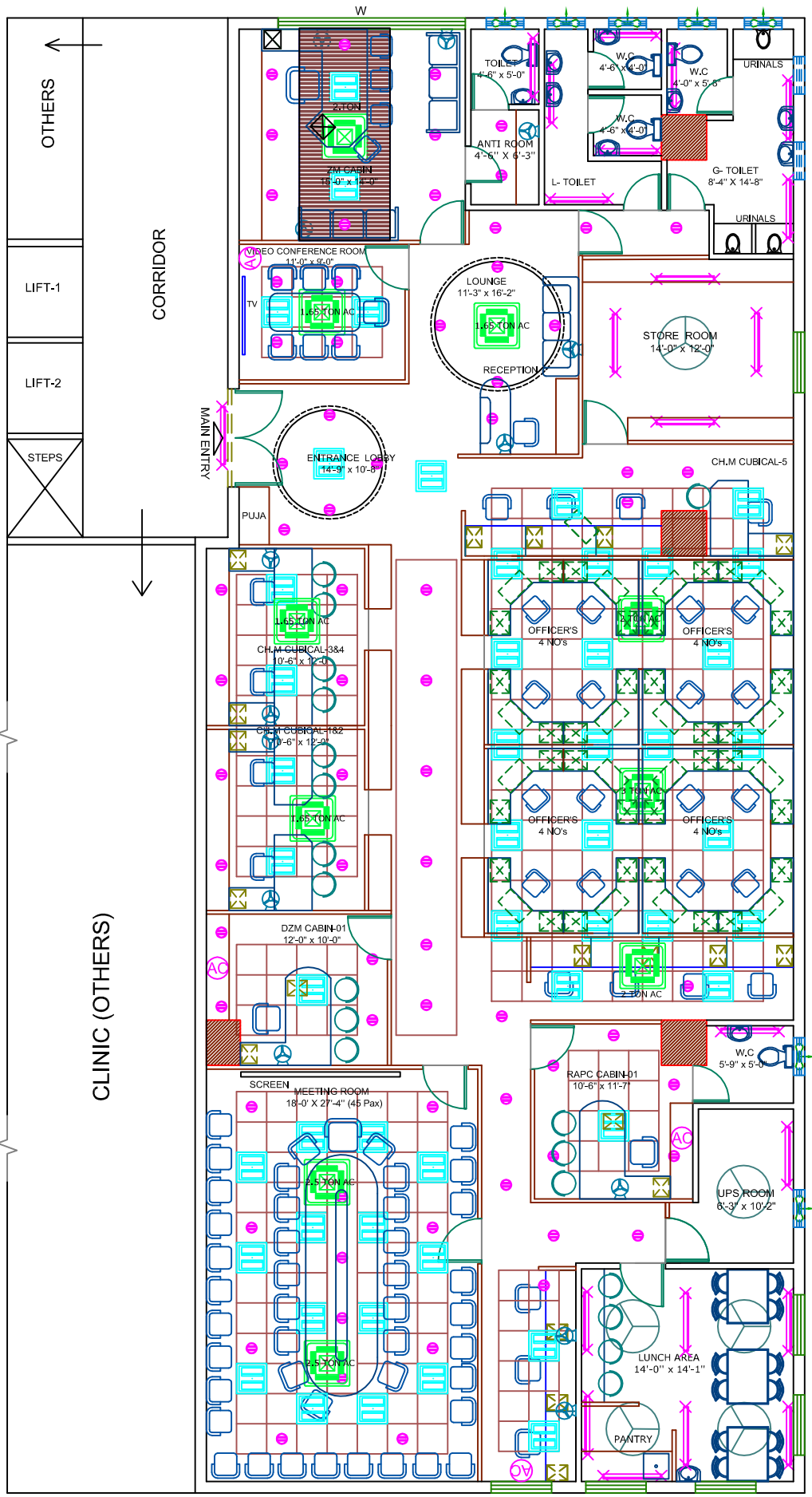

## INDEX:

- 1) ZM HEAD CABIN -01 No
- 2) D.Z.M CABIN -01 No
- 3) CH.MANAGER CUBICAL -05 No's
- 4) RECEPTION / SECURITY -01 No
- 5) WORK STATION-27 No's

TOTAL STAFF ..... = 27 No's.

- 6) MEETING ROOM - 45 Pax.
- 7) SUB STAFF -01 No's
- 8) LUNCH/ PANTRY ROOM -01 No
- 9) STAFF TOILE(L+G+ZM+AGM):  
2+1+1+1 WC
- 10) UPS -01 No
- 11) RAPC CABIN -01 No
- 12) RECORD ROOM -01 No

TOTAL AREA = 3671 Sft.

1. THIS DRAWINGS IS THE PROPERTY OF THE ARCHITECT AND SHALL NOT BE COPIED WITHOUT HIS PERMISSION.
2. DISCREPANCIES FOUND IN THE DRAWING SHALL BE BROUGHT TO THE ARCHITECT'S NOTICE IMMEDIATELY.
3. DRAWINGS SHALL BE READ AND SHOULD NOT BE SCALED.

## PROJECT :

PROPOSED INTERIOR'S FOR  
**INDIAN BANK**  
NEW ZONAL OFFICE  
MALKAJIRI ZO  
AT KUKATPALLY.

## DRG TITLE :

INTERIOR LAYOUT PLAN  
SECOND FLOOR

DESIGNED BY: FA  
DRAWN BY: GHAYAN  
CHECKED BY : FA  
DATE : 17-11-2025  
SCALE : NTS

OPTION - 13

## NORTH :



## ARCHITECT:

**FIROZ AHMED**, M.Arch.,

H.NO 13-6-436/A/33,  
LAKSHMI APARTMENTS,  
2nd FLOOR, 301, LAKSHMI NAGAR  
PILLAR NO.68, MEHIDIPATNAM,  
HYDERABAD-028.

CELL: 98481 49737

Sr. No.	DESCRIPTION	QNTY	UNIT	RATE	AMOUNT
<b>1</b>	<b>DISTRIBUTION BOARDS</b>				
	Supply and installation of following size MCB distribution boards with following combination of MCBs as required				
a	<b>MAIN PANEL:</b> <b>INCOMING:</b> MCCB 4P 415 volts 250 Amps rating 25 KA-01 Nos (Thermal based release), 2A, control fuse - 3 Nos, RYB indicating lamps - 1 set, Voltmeter (0-500V) with selector switch - 1 set, Ammeter (0-250A) with selector switch - 1 set, TPN Aluminium busbar of 250A with 25 KA fault level capacity, mounted on non-hygroscopic, glass fibre reinforced insulators-1set <b>OUTGOING:</b> i) MCB 4P 415 V 63 Amps rating 16 KA- 8Nos, ii) MCB 4P 415 V 40 Amps rating 16KA -2 Nos.iii) MCCB 4P 100A rating 25 KA -1 No.	1	no		
b	Supply and installation of 25 KVAR APFC panel, floor/wall mounted front operated totally enclosed vermin proof, indoor non-drawout-cubicle type power panel fabricated out of 2mm thk CRCA sheet having gasketed hinged cover on each cubicle fully powder coated with following accessories i)Incomer: 63A 25KA MCCB ii)Outgoing: 1 No. 10 KVAR,32A TPN MCB with contactor iii)3 no's. 5KVAR 16A TPN MCB WITH Capacitors -----Suitable bus bar for connecting the contactors and MCB's, Capacitors, 1 no. 4 step APFC relay suitable for above arrangement, ON/OFF/TRIP push button for each capacitor , ON/OFF/TRIP indication lamp for each capacitor, 1 Set, RYB, indicating lamps with resistors and fuses for incomer.	1	no		
c	S & I of 250A,FP, Changeover switch in sheet metal enclosure bypass	1	no		
d	4 way Three Phase Vertical DB( <b>with Double door</b> ) for Floor distribution board i)Incomer: 80A 4P 16KA MCB ii)Outgoing: a) 40A TP MCB 2Nos(ups db, Power db), b) 32A TP MCB 2 no's( lighting db , spare)	0	no		
e	3PHASE 6 way TPN (with Double door)- i)Incomer: 63A TPN MCB, ii)Outgoing: 6/10A SP MCB 18 Nos for <b>Lighting/Power db</b>	1	no		
f	3PHASE 4 way TPN (with Double door)- i)Incomer: 63A TPN MCB, ii)Outgoing: 6/10A SP MCB 18 Nos for <b>Lighting/Power db</b>	1	no		
g	1PHASE 8 way SPN - i)Incomer: 40A DP MCB, ii)Outgoing: 6/16A SP MCB 6 Nos for <b>UPS db</b>	1	no		
h	3PHASE 8 way TPN (with Double door)- i)Incomer: 63A TPN MCB, ii)Outgoing: 10/16A SP MCB 24 Nos for <b>AC/LP DB</b>	2	no		
<b>2</b>	<b>ENCLOUSERS</b>				
i)	40A TP MCB with weather proof encloser for UPS Input & OUTPUT	2	no		
ii)	63A TP MCB with weather proof encloser for AC	2	no		
iii)	16/20A DP MCB with weather proof encloser for Ac Units	0	no		
<b>3</b>	<b>PLUG TOP ARRANGMENT</b>				
i)	Providing 2 meter length of flexible 3core 2.5sqmm multi core copper cable one end connected to <b>plug top 15A</b> and the other connected to the SB inside and a suitable hook arrangement as required for hanging the cable at Record room.	2	Nos.		
<b>4</b>	<b>CABLES</b>				
i)	<b>SUBMAINS</b>				
a	Supply and laying following size 1.1KV grade PVC insulated armoured aluminium/Cu. FRLS conductor under ground cable on the surface of wall, above false ceiling along with 2runs of 12swg GI wire with all installation materials.The cable shall conform to IS 1554 Part- I.scope also includes termination of the cable as required with suitable glands and lugs				
	1)3.5C X 95 Sq.mm AL. Arm cable for MAIN INCOMING	180	mtr		
	2)3.5C X 35 Sq.mm AL. Arm cable for ACDB INCOMING ,CAPACITOR PANEL INCOMING	26	mtr		
	3)4C X 16 Sq.mm Cu. Arm Flx cable for TPN DB'S & AC	42	mtr		
	4)4C X 10 Sq.mm Cu. Arm Flx cable for TPN DB'S & AC	44	mtr		
	5)4C X 6 Sq.mm Cu. Arm Flx cable for DB'S	20	mtr		
	6)3C X 4 Sq.mm Cu. Arm cable for Cassette & split single phase Ac's	40	mtr		
	7)4C X 2.5 Sq.mm Cu. Arm cable for Cassette Three phase Ac's	92	mtr		

Sr. No.	DESCRIPTION	QNTY	UNIT	RATE	AMOUNT
b	Providing end terminations for following size cables including supply of Compression type cable gland, lugs, insulation tape and identification tags complete with end termination and earthing of gland.				
	1)3.5C X 95 Sq.mm AL. Arm cable for MAIN INCOMING	2	Nos		
	2)3.5C X 35 Sq.mm AL. Arm cable for ACDB INCOMING , MAIN VTPN DB & CAPACITOR PANEL INCOMING	2	Nos		
	3)4C X 10 Sq.mm Cu. Arm Flx cable for TPN DB'S	2	Nos		
	4)4C X 10 Sq.mm Cu. Arm Flx cable for TPN DB'S	2	Nos		
	5)4C X 6 Sq.mm Cu. Arm Flx cable for DB'S	2	Nos		
	6)3C X 4 Sq.mm Cu. Arm cable for Cassette & split single phase Ac's	7	Nos		
	7)4C X 4 Sq.mm Cu. Arm cable for Cassette Three phase Ac's	3	Nos		
	8)4C X 4 Sq.mm Cu. Arm cable for Cassette & split single phase Ac's	0	mtr		
c	3core 2.5sqmm Copper Conductor Cable for Glow Sign Board	68	mtr		
ii)	<b>POINT WIRING - LIGHTS &amp; CEILING FANS</b>				
a	Point wiring with 1.5sqmm FRLS 650V grade multistranded PVC insulated copper wire in 2mm thick 25mm dia PVC pipe for lights, fans including supply & fixing of 5 amp modular switch in concealed MS switch box,front plate, 3 plate ceiling rose, and concealed circuit wiring with 3 Nos (P,N,E) 2.5sqmm <b>(DB's to switchboards &amp; switch board to switch boards loopings)</b> . and all interconnections as required.	125	pts		
b	Same as above but for secondary points looped from the above	35	pts		
c	Same as point wiring but for the call bell points for the cabins including supply of call bell as required	4	pts		
d	Supply and fixing of 1nos. 6A sockets fixed the switch board with 1 no 6A switch including all interconnections as required for raw power (New Sockets) In Public area	4	no		
iii)	<b>POINT WIRING- WALL MOUNTING FANS :</b>				
	Wiring for the <b>wall mounting fans</b> from the nearest switch board with 1.5sqmm FRLS 650V grade multistranded PVC insulated copper wire in 20mm dia 2mm thick PVC pipe and all interconnections as required including the supply and fixing of 6A modular socket 3" below the false ceiling and 6A switch in the switchboard as required.	28	nos		
5	<b><u>SOCKETS - RAW :</u></b>				
a	<b>RAW Socket - 1 x 6A</b>				
i)	Supply and fixing of 1nos. 6A socketsfixed Above the table with 1 no 6A switch fixed above the table on 3 module metal box and white front plate (Modular type)with 2runs of 2.5 sq.mm FRLS and 1 run of 1.5sqmm FRLS 1100 V grade PVC insulated multi strand copper conductor wires conforming to IS 694 (with latest amendments) in 25mm dia PVC conduit of 2mm thick concealed in wall/floor and supply of all fixing materials and accessories,interconnections complete as required for the raw power primary sockets (DB to work stations Primary point)	32	no		
ii)	same as above but looped from nearest Raw Power point (Primary point to Secondary point)	18	no		
b	<b>RAW Socket - 1 x 5/15A</b>				
i)	Supply and fixing of 1nos. 6/16A sockets with 1 no16A switch fixed on a suitable module metal box and white front plate (Modular type) wiring with 2runs of 4.0 sq.mm FRLS and 1 run of 2.5sqmm FRLS 1100 V grade PVC insulated multi strand copper conductor wires conforming to IS 694 (with latest amendments) in suitable size PVC conduit of 2mm thick concealed in wall/floor and supply of all fixing materials and accessories,interconnections complete as required for the raw power primary sockets (DB to Primary point)	6	no		
ii)	same as above but looped from nearest Raw Power point(Primary point to Secondary point)	2	no		

Sr. No.	DESCRIPTION	QNTY	UNIT	RATE	AMOUNT
	<b><u>SOCKETS - UPS:</u></b>				
a	<b>UPS Socket - 3 x 6A</b>				
i)	Supply and fixing of 3nos. 6A sockets with 1 no 16A switch fixed on a suitable module metal box and white front plate (Modular type) including all interconnections as required (switch shall be fixed above the table with suitable modular front plate /box and sockets shall be fixed below the counters) with 3runs of 2.5 sq.mm FRLS grade 1100 V PVC insulated multi strand copper conductor wires conforming to IS 694 (with latest amendments) in suitable size PVC conduit of 2mm thick concealed in the above ducts in the floor and supply of all fixing materials and accessories, interconnections complete as required for the UPS power sockets. (DB to work stations Primary point)	34	no		
ii)	same as above but looped from nearest UPS Power point (Primary point to Secondary point)	22	no		
b	<b>UPS Socket - 2 x 16A</b>				
	Supply and fixing of 2nos. 6/16A sockets with 1 no 16A switch fixed on a suitable module metal box and white front plate (Modular type) with 2runs of 4.0 sq.mm FRLS and 1 run of 2.5sqmm FRLS 1100 V grade PVC insulated multi strand copper conductor wires conforming to IS 694 (with latest amendments) in suitable size PVC conduit of 2mm thick concealed in wall/floor and supply of all fixing materials and accessories, interconnections complete as required for the UPS power primary sockets (DB to Primary point)	4	no		
	<b><u>TELEPHONE &amp; DATA :</u></b>				
a	Supply and fixing of RJ 11 Telephone socket with 2 Pair (0.5mm) Telephone Cable From Each Table to Krone Box, this include suitable Surface/concealed box and all required materials this Includes Wiring. Supply and fixing of Suitable PVC Conduits and Cable Numbers to provided.	45	nos.		
b	Supplying and fixing a 20 pair krone connector in a suitable box as required. Mintanance room	1	nos.		
c	Supply and Laying of 4Pair, UTP(Unshielded Twisted Pair) cat6 Lan Cable with Information outlet and Suitable 2mm Thick PVC Pipe Laying Below Flooring/Wall/Slab etc MS Junction Boxes to All Tables, Including all Related Civil Works etc All Cable Numbers to be Provided at both ends	86	nos.		
d	supply & fixing of 7 feet Patch Cords.	86	nos.		
e	supply & fixing of 3 feet Patch Cords.	86	nos.		
f	<b>Supply &amp; Fixing</b> of 24 Port Jack Panel & switch	4	nos.		
g	<b>Supply &amp; Fixing</b> of 9U Rack with Acceries(Self, Power Manager, Cable Manager, Fan etc)	2	nos.		
g	<b>Supply &amp; Fixing</b> of 12U Rack with Acceries(Self, Power Manager, Cable Manager, Fan etc)	2	nos.		
<b>6</b>	<b>PA &amp; MUSIC SYSTEM</b>				
a	S & I of point wiring for music - cum PA system comprising of 2x 1.0 sqmm stranded , copper conductor , flexible PVC insulated and PVC Sheathed wire pulled through 20 mm dia PVC heavy gauge conduits and looped from one speaker to other and to the volume control and control switch wherever applicable and finally terminated at Tag Block.	10	Pts.		
b	S & I of Philips / Bosch/Ahuja make music 6W (101.6mm Diameter) speaker flush mounted on the false ceiling with proper clamping arrangement	10	nos.		
c	S & I of volume control - cum - ON - OFF switch flush mounted on wall along with other electrical switches .The size and plate of the regulating knob should match with other switches nearby (MK make)	1	nos.		
d	S & I of 200 Watts BOSCH/Ahuja make Central Music System Amplifier and MP3/CD/USB Player with FM facility of make Samsung/Onida/LG	1	SET		
e	S & I of TV socket point flush mounted on wall / partition including cabling till outside the builing with connector	4	nos.		

Sr. No.	DESCRIPTION	QNTY	UNIT	RATE	AMOUNT
<b>7</b>	<b>SUPPLY AND INSTALLATION OF LIGHTING FIXTURES</b>				
	Supply & Installation of following type Fluorescent / Compact fluorescent / Incandescent light fixtures. The fixtures shall be installed including supply and wiring between Ceiling rose to fixture with supply and laying of 3core 1.5Sq.mm copper flexible cable and fixing of Lamp with all required accessories, support chains & interconnections etc.				
a	Supply & Installation of 15W Led down light fixture. <b>(Havells / Philips:- ENDURANEODLR15WLED840S or Equ)</b> including cost and conveyance of all materials, taxes and all labor charges etc., complete.	65	Nos		
b	Supply & Installation of 12W Led down light fixture. <b>(Havells / Philips:- EDGEPRORDDL12WLED840S or Equ)</b> including cost and conveyance of all materials, taxes and all labor charges etc., complete.	15	Nos		
c	Supply & Installation of 34W 2X2 Led Light fixtures <b>(Havells /Philips- PLUTOSURFACE2X2PLS34WLED840S or Equ)</b> including cost and conveyance of all materials, taxes and all labor charges etc., complete.	50	Nos		
d	Supply & Installation of 9W Led Wall bracket Light fixtures including cost and conveyance of all materials, taxes and all labor charges etc., complete.	5	Nos		
e	Supply & Installation of 18 W T5 led Light fixtures and giving connections and all labour charges etc., complete for erection. <b>(TITANIASLEEK1149T5DSTL18WLED865SPC - Havels or Equ)</b>	24	Nos		
f	Recess mounted LED strip light in concealed Aluminium profile / channel (15/17mm wide , with push button, fixed at ceiling .	38	Rmt		
<b>f</b>	<b>Wall Mounting Fans</b>				
	Supply and Fixing of wall mounted fans of approved make 400mm Hi flow model.	22	Nos		
<b>g</b>	<b>Ceiling Mounting Fans</b>				
	Supply and fixing of 1200mm (48") size ceiling fan Metallic hi speed Crompton Greves Rivera model with 120W step type regulator (Including 2F lenth down road and Hooks) of approved makewith all connections and anchor fasteners ,fan hooks, down rods etc as required	6	Nos		
<b>h</b>	<b>Exhaust Fans</b>				
	Supply & Installation of 300mm (12") size fresh air exhaust fan light duty , Metallic body plastic blades, wire mesh, bird louvers etc. including cost and conveyance of all materials, taxes and all labor charges etc., complete for erection	7	Nos		
<b>8</b>	<b>EARTHING</b>				
a	Providing standard copper plate earth station ,with 600x600x3.15mm thick copper plate, 40mm dia, 2.5 mtr GI pipe with 25X3 copper strips runs on both sides up to top of the earth pit including excavation and construction of brick pedestal providing meshed funnel, CI cover and other Civil works, spreading a homogenous mixture of salt, charcoal around the plate etc completely as per IS 3043,1987 or latest revision	2	nos		
b	Providing G.I earth station, with 40mm dia, 2500mm long galvanized iron pipe including construction of brick pedestal providing meshed funnel CI cover and other Civil works, spreading a homogenous mixture of salt charcoal around the pipe etc., Completely as per IS 3043,1987 or latest revision.	2	nos		
c	Supply & Laying of 100mmX 25mmX 5mm Copper strip with supporting insulator and holes	1	nos		
d	Supply and laying of 8SWG CU Wire in 20mm dia rigid pvc conduit for ups DB earthing from the existing earth pits in PVC conduit of suitable size.	162	mtr		
e	Supply and laying of 8SWG GI Wire in 20mm dia rigid pvc conduit for Raw power & Lighting DB earthing from the existing earth pits as required in PVC conduit of suitable size.	162	mtr		
<b>9</b>	<b>FLOOR -RACEWAYS: (Separate race ways to be provided for data/voice and power cables)</b>				
a	S & I of floor - raceways consisting of 1 Run of 100x40x 2 mm thick rectangular aluminium anodized box sections including chasing and refilling as per the route shown in the drawing and as approved by consultant at site including clamping at every open pipe ends by suitable plastic end covers against entry of dust or anyother foreign material.	32	mtr		

Sr. No.	DESCRIPTION	QNTY	UNIT	RATE	AMOUNT
b	S & I of galvanised floor junction boxes with SS brushed finish 14 SWG ( 2mm Thick) cover properly fixed with screws, for above mentioned raceways , of size 350mm x 350mm x 50 mm depth, fabricated out of 2 mm thick G.I. sheet with proper cutouts on the sides for pipe entry & screwed top cover with rubber gasket and suitable knockouts for flexible conduit outlets as per the drawing enclosed.	2	no.s		
c	S & I of galvanised floor junction boxes with SS brushed finish 14 SWG ( 2mm Thick) cover properly fixed with screws, for above mentioned raceways , of size 250mm x 250mm x 50 mm depth, fabricated out of 2 mm thick G.I. sheet with proper cutouts on the sides for pipe entry & screwed top cover with rubber gasket and suitable knockouts for flexible conduit outlets as per the drawing enclosed.	4	no.s		
d	S & I of galvanised floor junction boxes with SS brushed finish 14 SWG ( 2mm Thick) cover properly fixed with screws, for above mentioned raceways , of size 150mm x 150mm x 50 mm depth, fabricated out of 2 mm thick G.I. sheet with proper cutouts on the sides for pipe entry & screwed top cover with rubber gasket and suitable knockouts for flexible conduit outlets as per the drawing enclosed.	4	no.s		
10	MISCELLENOUS WORK				
a	Supply & Installation of rubber mats of 2000 mm x 600mm & thickness of 10mm				
	1.1 KV Voltage grade.	2	no.s		
	GRAND TOTAL				
	Rupees.				
	GST EXTRA				

ESTIMATIONS AND SPECIFICATIONS FOR THE PROPOSED INDIAN BANK, MALKAJGIRI ZONAL OFFICE, HYDERABAD.					
S.NO	DESCRIPTION	UNIT	QTY	RATE	AMOUNT
<b>A</b>	<b>PART - A - HIGH SIDE</b>				
<b>1</b>	Condensing Unit (Outdoor Unit):				
	The condensing unit shall be capable of assessing the requirement of liquid refrigerant flow of each evaporating unit at all times by means of a micro computer control expansion valve and generating the required total flow of refrigerant liquid for supply to the evaporator units. The condensing unit shall be modular type, designed as per Indian atmospheric conditions and should be capable to perform for outside ambient 50 Deg. C. Outdoor Units should be modular in type and should be equipped with DIP IPM type Inverter Scroll Compressor, Inverter with variable speed compressors capable of changing the capacity in accordance to the cooling load requirement with highest COP/EEER. Provision of setting External Static Pressure up to 60Pa by on site. Unit COP/EEER should be high and designed for cooling operation for highest ambient Temperature as per Indian atmospheric conditions.				
	Set of Outdoor Unit should be able to connect up to 64 Indoor Units. Outdoor unit should consists of DC variable speed motor for condenser fan with minimum 25 steps speed control to reduce input power, auto check function for connection error, auto address setting. Unit should be equipped with a double stage highly efficient oil separation management system to ensure minimum oil entrainment and proper lubrication with high reliability and stable operation with long refrigerant piping. The noise level of the base unit shall be less than 60dB (A) when measured horizontally 1 m away from cover surface and 1.5 m above floor level during night shift. Unit should assess demand function automatically and perform with the help of Central Station. Units having Noise reduction mode will be preferred but must be having back up operation function for emergency to avoid complete stop. Outdoor unit should have feature of Rotation Operation function of Compressor to distribute load.				
	The condenser coil should be with internally grooved Cu tubes, mechanically bonded to super slit aluminum fins. The surface of the condenser coil shall be coated with suitable chemical coating to prevent deterioration due to climate. Outdoor unit must have automatic judgement function to check whether or not the refrigerant amount is sufficient in one refrigerant cycle. Reliable Transmission system should be used between outdoor and indoor units. All necessary safety devices shall be provided to ensure safe operation of the system.				
<b>1.1</b>	14 HP Outdoor Unit	Nos	1		
<b>1.2</b>	5 HP Outdoor Unit	Nos	1		
<b>2</b>	Supply of <b>CASSETTE UNITS</b> type indoor units comprising with pre-filter, fan section with low noise fan multi speed motor, coil section with DX coil, outer cabinet, drain water lift-up mechanism, insulation, pipe connections etc. of various capacities as per specifications and drawings. <b>WITH CORDLESS REMOTE CONTROL</b>				
<b>2.1</b>	1.65 Ton 4way Cassette	Nos	3		
<b>2.2</b>	2.0 Ton 4way Cassette	Nos	2		
<b>2.3</b>	2.5 Ton 4way Cassette	Nos	3		
<b>2.4</b>	3.0 Ton 4way Cassette	Nos	0		
<b>3</b>	Supply of <b>HI-WALL UNITS</b> type indoor units comprising with pre-filter, fan section with low noise fan multi speed motor, coil section with DX coil, outer cabinet, insulation, pipe connections of various capacities as per specifications and drawings. <b>WITH CORDLESS REMOTE CONTROL</b>				

Contractor Signature



3.1	1.5TR Capacity	Nos	2		
3.2	1.0 TR Capacity	Nos	0		
4	Refnet Joints for Indoor units FOR BOTH LIQUID & SUCTION LINE. (only one unit will be considered for both suction and liquid lines)	Nos	10		
5	<b>SPLIT TYPE AIR CONDITIONERS</b>				
	1.5 TR wall mounted split unit (Minimum 5-Star rating inverter type) including all necessary fittings and mountings as specified by the manufacturer.	Nos.	3		
	2.0 TR wall mounted split unit (Minimum 5-Star rating inverter type) including all necessary fittings and mountings as specified by the manufacturer.	Nos.	1		
	including all necessary fittings and mountings as specified by the manufacturer (Three phase). ( 5 star or Equivalent energy saving latest model Inverter Type)				
	<b>Total Amount Part -A</b>				
B	<b>LOW SIDE WORKS</b>				
1	Lifting, Shifting, Positioning & Installation of VRF Outdoor units ( 3nos.)	Nos	2		
2	Lifting, Shifting, Positioning, Installation , Commissioning and Testing of VRF Indoor units	Nos	14		
3	Vacuuming the system, Gas filling and topping up with R410-Ozone Friendly and NonCFC Refrigerant, pressure testing and commissioning of above system.	Per / HP	19		
4	Supply & installation of suction & discharge Hard copper Refrigerant piping with proper supports/hangers from ceiling/wall as required at site & approved by consultant & duly insulated with closed cell elastomeric nitrile insulation of 19mm thick for pipes above 1" and 13 mm thick for pipes below 1" as suggested by the manufacturer. (only one length will be considered for both suction and liquid lines)				
4.1	31.75 mm	Rmt	182		
4.2	28.58mm				
4.3	25.4mm				
4.4	22.2mm				
4.5	19.05mm				
4.6	15.9mm				
4.7	12.7mm				
4.8	9.37 mm				
4.9	6.35mm				
6	Supply and Erection of hard PVC condensated drain piping with 9mm thick Nitrile insulated including support and wall opening of the following sizes etc..				
6.1	a) 40mm Dia	Rmt	22		
6.2	b) 32mm Dia	Rmt	32		
6.3	c) 25mm Dia	Rmt	106		
7.1	Supply and Laying of Control and communication cable and connecting the VRF IDUs and ODUs (control wiring using 3C X 1.5 Sq.mm shielded copper cable) with PVC conduit	Rmt	212		
8.0	<b>MS Stand</b> for placing outdoor units Outdoor Flat form/stand work for mounting / accessing of Outdoor units for all the above AC units. As per site condition stand should be prepared and should have proper structural Including required scfoholding and civil works strength that shall be done in consultation with Engineer.	Kgs	600		

Contractor Signature

<b>9.0</b>	<b>AIR-CONDITIONERS STAND</b>				
	<b>Powder coated readymade stands For Hi Wall split units</b>	Nos	<b>4</b>		
<b>10.0</b>	<b>Associated Civil works</b>				
	Chipping ,chasing & Plastering the wall openings in cement mortar 1:6 of 15 mm thick finishing to line and level with sand facied finishing at all levels, including all leads & lifts, scaffolding, curing etc complete (for Copper & Drain openings in all rooms etc.	Lot	<b>1</b>		
	<b>TOTAL AMOUNT -B</b>				
	<b>GRAND TOTAL AMOUNT (PART-A + PART-B)</b>				
	<b>Note: GST Extra as Applicable</b>				

Contractor Signature